

## SPECIFICATIONS

Product Description: **VENTILATION BLOWER, EXPLOSION-PROOF**  
Part Number: **9503-E**  
Style: **CENTRIFUGAL FAN, 220V/50Hz**

### GENERAL DESCRIPTION:

Smart compact design allows for easy use and storage without sacrificing airflow. It meets explosion proof requirements. Two 8" (20.3 cm) ports offer positive ventilation or fume extraction.

### CONSTRUCTION:

- 8" (20.3 cm) flange on intake and exhaust side
- Tough safety orange polyethylene construction
- One-piece housing with integrated handle
- 12-gauge, black powder coated steel base
- Steel handle
- Aluminum blower wheel with aluminum hub
- Steel black powder coated grill
- Equipped with five rubber feet
- *NOTE: EX blowers require an explosion-proof socket (PN 9503-06)*



### MOTOR:

HP: 3/4 HP, UL Listed, CSA Certified, CE Registered  
Voltage: 220V AC, 50 Hz, Single Phase  
Max RPM: 1425 (Loaded at 220V, 50 Hz) Nom EF: 66%  
Current Draw: 4.8A  
Cord: 25' (7.62 m) SJOOW, 12/3 AWG, 90C 300V  
Plug: NEMA 220V 20A, Hazardous Location "ECP" Type

### HAZARDOUS LOCATION RATING:

Class: I	Class: II
Division: 1 & 2	Division: 1 & 2
Group: D	Group: F & G

### DUCTING: (Optional)

- Black, single-ply lightweight vinyl/polyester, neoprene coated (250° F (121.1° C) temp. resistant)
- Retractable, non-collapsible design, Class I, hard drawn spring steel wire helix, ASTM 227 Specs
- *WARNING: When using statically conductive ducting, the integrated grounding wire must be properly grounded to the blower chassis OR linked to any additional grounding wire or duct used (as shown). Refer to User Manual for detailed instructions.*

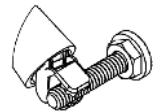

### BLOWER DIMENSIONS:

Length	Width	Height	Weight
21" (53.3 cm)	17" (43.1 cm)	19" (48.2 cm)	76 lbs. (34.4 kg)

### FLOW RATES: (CFM calculated using 15' (4.57 m) of 8" (20.3 cm) ducting)

Free Air	One 90° Bend	Two 90° Bends
1300 CFM (2208.7 m <sup>3</sup> /hr)	915 CFM (1554.5 m <sup>3</sup> /hr)	750 CFM (1274.2 m <sup>3</sup> /hr)